

Corrigendum

Name of Work: Augmentation of Existing Electrical Distribution system for Phase- 1 (In Substation- 2, 3, 4 and Hospital Block) at AIIMS Raipur.

NIT No. : 48/EE/AIIMS/RPR/2020-21 Dated 12/10/2020

Changes to be considered in the above referred Notice Inviting Tender

SN.	Clause/ Page/ Point	Existing	To be read as
1.	Approved materials list (electrical) at page no. 61/ Item no. 1	LT Panels : Siemens / L & T/ Schneider/ C & S/ ABB/ Advance Panel	LT Panels: Siemens / L & T/ Schneider/ C & S/ ABB/ Advance Panel Note: In addition to Approved makes, LT Panels from Licensed partners of Original equipment manufacturer (Siemens / L & T/ Schneider/ C & S/ ABB) who are authorized to fabricate LT panel as per design, drawing of OEM are also acceptable. The panel builder shall produce type test certificates of panels and valid design from OEM. The panels shall be manufactured as per conditions specified in IEC: 61439. The panel shall bear the Logo of OEM also.
2.	-----	Nil (Addition)	Front and side view drawing of Installed LT panel for design of Adaptor panel enclosed herewith as Annexure-J.
3.	Electrical panel details (Pg no. 40-42) and Electrical panel drawing (Pg no. 68-71).	-----	All the MCCB indicated for Incoming and Outgoing of Panel Type- A,B,C,D are to be read as 4 pole MCCB.

Note:

- a) All other terms & condition will be remaining unchanged.
- b) All uploaded Corrigendum/ Addendum become part of Tender document and must be submitted along with technical bid as acceptance.

The Tender forms and other details can be seen / downloaded from the website www.aiimsraipur.edu.in and CPPP web site <https://eprocure.gov.in/eprocure/app>.

Er. Manoj Rastogi
Executive Engineer (Civil)
All India Institute of Medical Sciences, Raipur

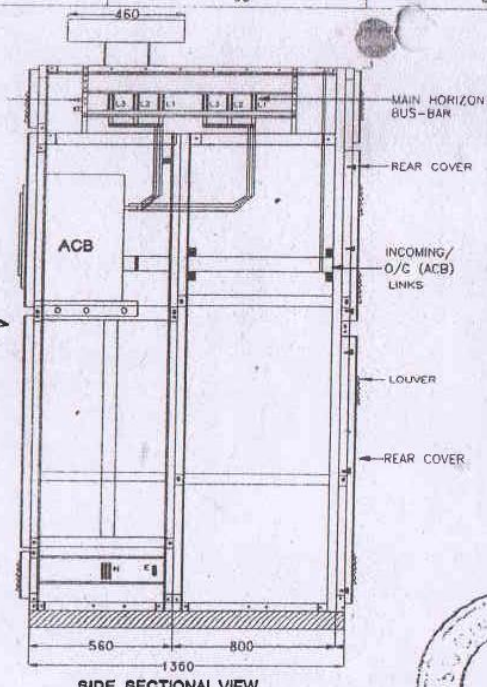
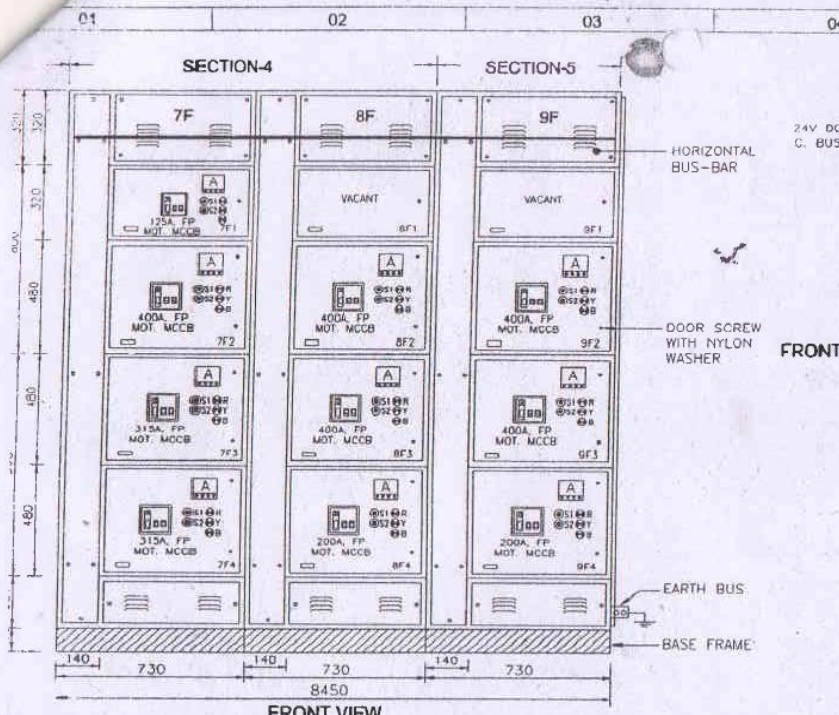

LEGENDS	DESCRIPTION
R	R- PHASE INDICATION 'RED'
Y	Y- PHASE INDICATION 'YELLOW'
B	B- PHASE INDICATION 'BLUE'
H1	ON INDICATION 'RED'
H2	OFF INDICATION 'GREEN'
H3	TRIP INDICATION 'AMBER'
H4	SPRING CHARGE 'BLUE'
H5	ILPB,TRIP CKT. HEALTHY INDICATION 'WHITE'
1H1	24V DC SUPPLY HEALTHY INDICATION 'RED'
MF	MULTIFUNCTION METER
A	AMMETER 96S0mm
BCS	BREAKER CONTROL SWITCH
MCB	MINIATURE CIRCUIT BREAKER
ACB	AIR CIRCUIT BREAKER
EDO	ELECTRICALLY OPERATED DRAWOUT TYPE

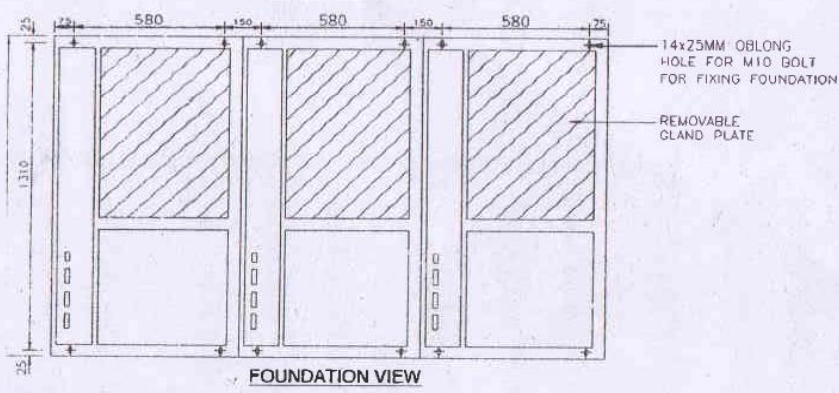

BUS BAR SIZE :-

PHASE : 2x2x200X10 mm AL.

NEUTRAL : 3x100X10 mm AL.

EARTH : 1:50X10 mm GI.

CABLE ENTRY : BOTTOM ONLY

CONTROL BUS BAR :

PHASE : 5X5 mm CU

NEUTRAL : 5X5 mm CU

NOTE:- ALL POWER SWITCHGEAR (65KA) RATING (ACB-3WL & MCCB-3VL)



SIEMENS (SIEPAN 8PU)

Item	Contractor	Consultant	Cable	Paint Shade	Main Bus-M/Cu	Panel Design	No. of Power Cables	No. of Fronts	Power System	Ambient Temp	Temp rise	Control system	Type tested Switchboard for	Technology by SIEMENS
101 Project:	AIMS RAIPUR	HOSPTECH MANAGEMENT CONSULTANT (P) LTD	Top/Bottom	RAL 7035	ALUMINIUM	--			433V/50Hz	50°C	3Ph+N+E	230V AC	65KA/1Sec	65KA/1Sec
End Customer:	Ministry of health and family welfare (GO)	Contact No. 011-26015321	Front access	Colour	Cland Plate	Neutral Bus				45°C			65KA/1Sec	65KA/1Sec
Contact No.	---	Approved	Rear access	Size	Earth Bus								65KA/1Sec	65KA/1Sec
Site requirement		Approved	Ventilation box	IP protection	Control Bus								65KA/1Sec	65KA/1Sec
			YES	IP 42/IP 52									65KA/1Sec	65KA/1Sec

**MAIN LT PANEL SUB STATION No.-2
A/C PLANT FOR HOSPITAL**



Rev	00
Sheet No.	02 OF 03
Next Sheet	
Job No.	
Date	1/2/21
Draw. Ref.	
Scale	1:1
Project	MAIN LT PANEL SUB STATION No.-2
Draw. No.	E-301-12518
Scale	1:1
Project	CENTRAL ARRANGEMENT DIAGRAM
Draw. No.	
Scale	
Project	
Draw. No.	
Scale	
Project	
Draw. No.	
Scale	